

#	DESCRIPTION	PART NUMBER	QTY
1	Silenziatore / Muffler L.400 Ø155	OVAL	1
2	Protezione in gomma per staffa / Rubber protection	50.73.041.1	1
3	Staffa / Bracket	50.SS.002.0	1
4	Vite M8x40 / Screw M8x40	50.73.075.1	1
5	Rondella in alluminio / Aluminium washer	50.73.063.1	1
6	Distanziale in alluminio / Aluminium spacer (Øe.30)	50.SS.645.1	1
7	Dado M8 flangiato / Flanged nut M8	50.73.393.1	1
8	Staffa / Bracket	50.SS.1325.0	1
9	Rondella in alluminio nera / Black aluminium washer	50.73.221.1	1
10	Vite M8x25 / Screw M8x25	50.73.064.1	1
11	Tubo di raccordo / Link pipe	9773H079SE	1
12	Fascetta Ø 48/51 mm / Pipe clamp Ø 48/51 mm	50.FA.007.1	1
13	Fascetta con bussola / Pipe clamp with bush	50.73.333.0	1
14	Cover in carbonio / Carbon cover	50.CR.054.1	1
15	Rondella M6 / Washer M6	50.72.027.1	3
16	Vite M6 x 8 / Screw M6 x 8	50.72.026.1	3
17	Gommino per molla / Rubber pipe	50.73.049.0	1
18	Molla media / Middle spring	50.73.359.1	1
-	DB killer	50.DK.020.0	1

Telaio / Frame

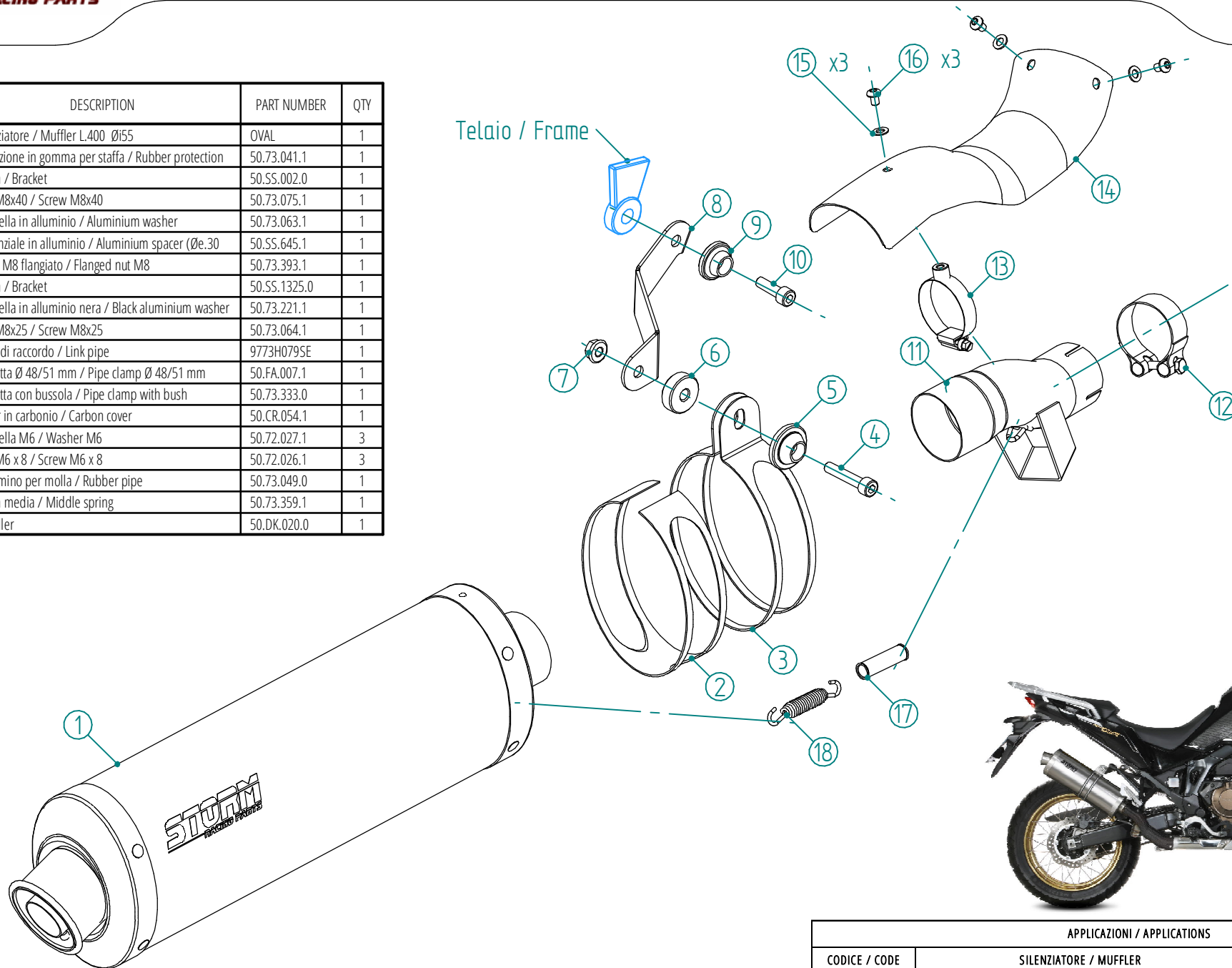

! NOTA: L'installazione di questo scarico prevede la rimozione dei cavi di comando del motore della valvola
 NOTICE: The installation of this exhaust involves removing the valve motor control cables

APPLICAZIONI / APPLICATIONS			
CODICE / CODE	SILENZIATORE / MUFFLER	TUBO / PIPE	FASCETTA / CLAMP
74.H.079.LX2	INOX / ST. STEEL	INOX / ST. STEEL	INOX / ST. STEEL
74.H.079.LX2B	STEEL BLACK		